

AUXILIA

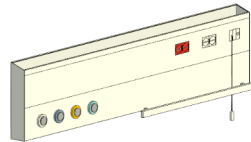

TRIAL

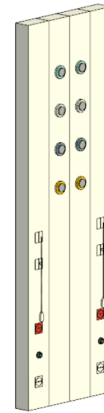

THERAPY VG

## Families

Revit families are developed by model.

- AUXILIA L\_ATENALUX.rfa
- AUXILIA LD\_ATENALUX.rfa
- AUXILIA LDG.2\_ATENALUX.rfa
- AUXILIA LDG\_ATENALUX.rfa
- AUXILIA LDGS.2\_ATENALUX.rfa

## Family types

The configurations of the various products are set within the family types.

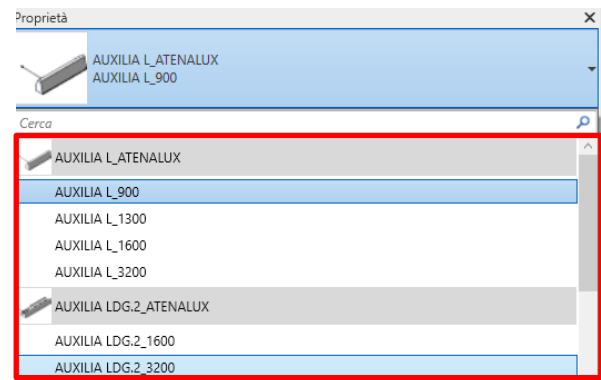

## Setting the object

Detailed product configurations can be set through instance and type parameters.

### Instance parameters

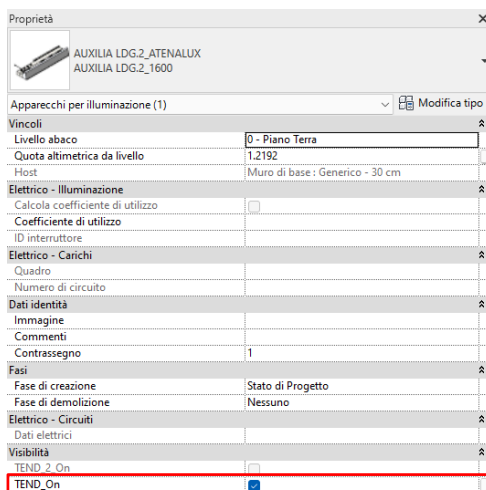

Type of finish

Each light has predefined dimensions stored as TYPE; it is possible to change the dimensions of the element, but the performance and identity data will not be updated automatically. Consider de

Optional visibility of the tend



### Type parameters

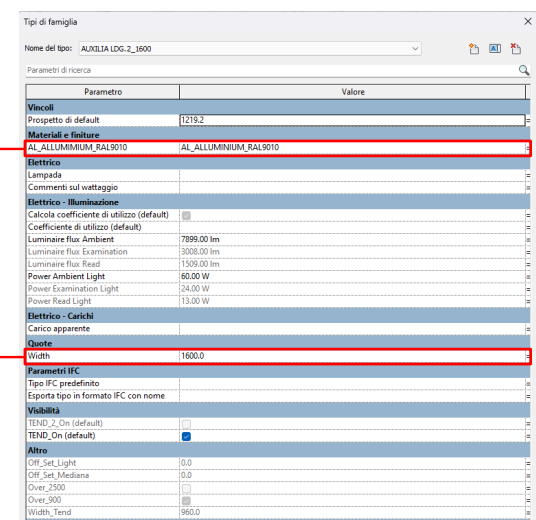

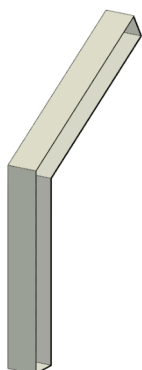

GAP 120

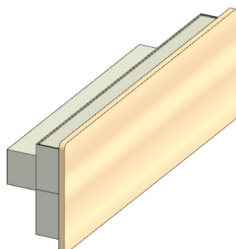

WAY WALL

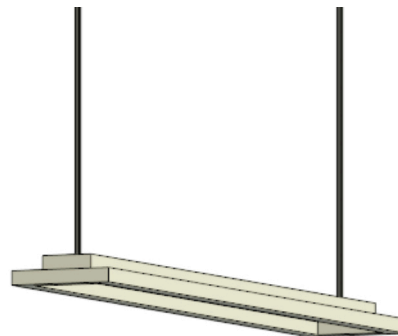

TOUCH

## Families

Revit families are developed by model.

- GAP\_ATENALUX\_90.rfa
- GAP\_ATENALUX\_90\_V.rfa
- GAP\_ATENALUX\_120.rfa
- GAP\_ATENALUX\_PMO.rfa
- GAP\_ATENALUX\_PMO\_AS.rfa
- GAP\_ATENALUX\_PMO\_IP54.rfa
- GAP\_ATENALUX\_PMO\_SOSPESO.rfa
- GAP\_ATENALUX\_PST.rfa
- GAP\_ATENALUX\_PST\_IP54.rfa
- GAP\_ATENALUX\_PST\_SOSPESO.rfa
- GAP\_ATENALUX\_X\_JOINT.rfa
- GAP\_ATENALUX\_Y\_JOINT.rfa

## Family types

The configurations of the various products are set within the family types.

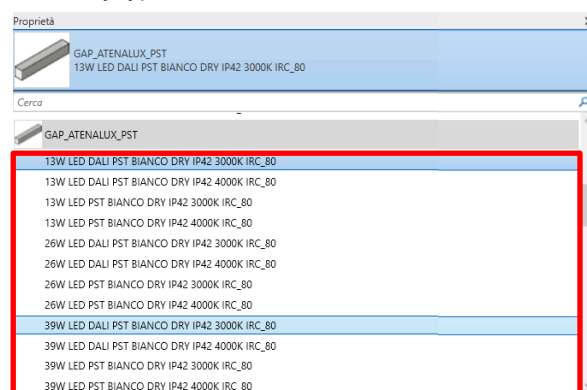

## Setting the object

Detailed product configurations can be set through instance and type parameters.

### Instance parameters

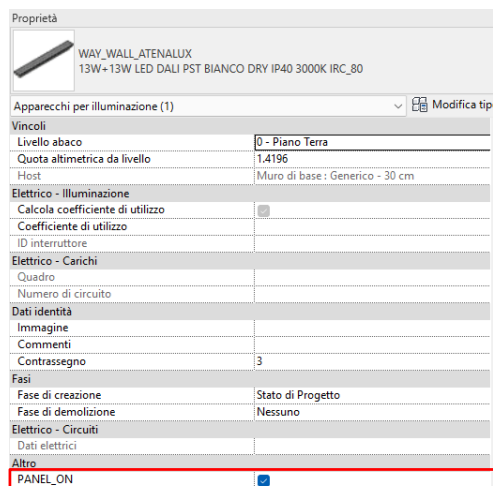

Type of finish

Lumen and power values

Photometric parameters

Optional visibility of the panel

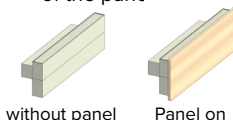

### Type parameters

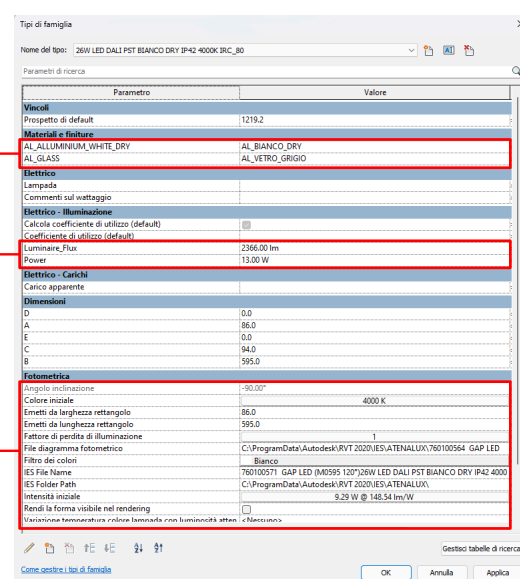



## Setting the IES's files

Each Lighting model works with his own IES file that is located in a specific folder, called “IES” (see image above). The first time a user download a BIM model **has to copy** the IES folder in the **corresponding** Path or change the path in the parameter's value.

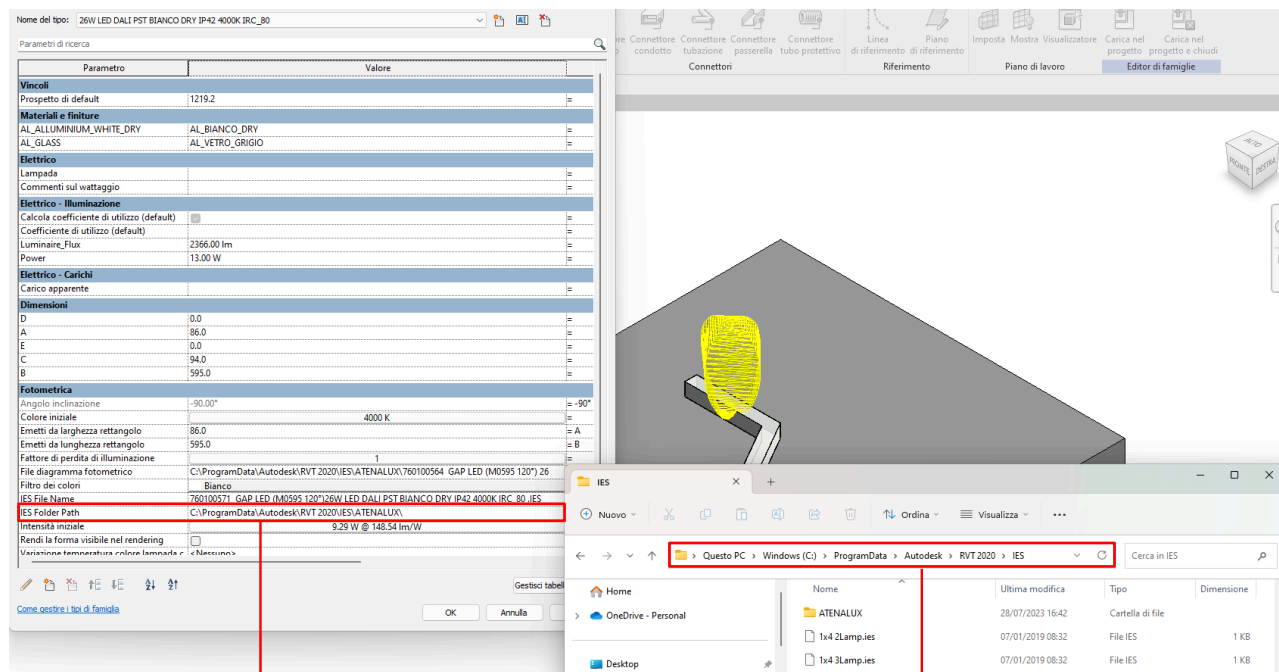

Path to the IES folder

Path of the IES folder